

A - A

- 17-Rafter
- 55-light transmitting flexible tube
- 189-double seal (white plastic material)
- 190-transparent diffuser PMMA with UV filter
- 191-mat diffuser PMMA with UV filter
- 192-ceiling frame
- 263-polyvinyl tape (fix and tight type)
- 342-ceiling strap
- 344-screw fixing ceiling frame
- 345-screw fixing the light transmitting tube
- 346-dome
- 347-seal
- 348-dome holder
- 349-clamp nut
- 350-SLZ FAKRO flashing
- 351-flashing frame
- 352-electric-light fitting SLO

SLTØ[mm]	X[mm]	Y[mm]
350	470	550
550	820	860

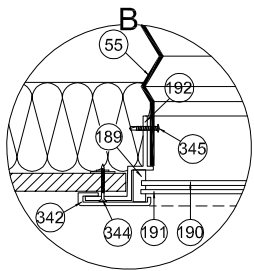

SLT	SLZ	TILE	15° - 60°

Warning! The present drawing is for informational-demonstrative purposes only and as such cannot constitute a basis for performance. All dimensions presented in this drawing should be verified on site. Because of the fact that the drawing is a schematic one, FAKRO shall not assume any responsibility for the actual installation quality on the roof. This drawing is FAKRO's property and cannot be published or used publicly without our written consent.

Vertical and horizontal cross-section:
FAKRO Light Tunnel SLT with SLZ flashing for profiled roofing materials

FORMAT: A4
SCALE: 1:10/1:5
DATE: 07.2011